

# Letters

September

NEXUS Newsletter

2003

Someone once said that people are equipped with two ears and one mouth for a reason. We have been asked if the NEXUS Modular Sign System could be designed to weigh less. Never let it be said that we don't listen!

NEXUS introduces the new **MultiBase** System.

Developed with single plate signs in mind, the **MultiBase** is 33% lighter than the traditional NEXUS MountPlate.

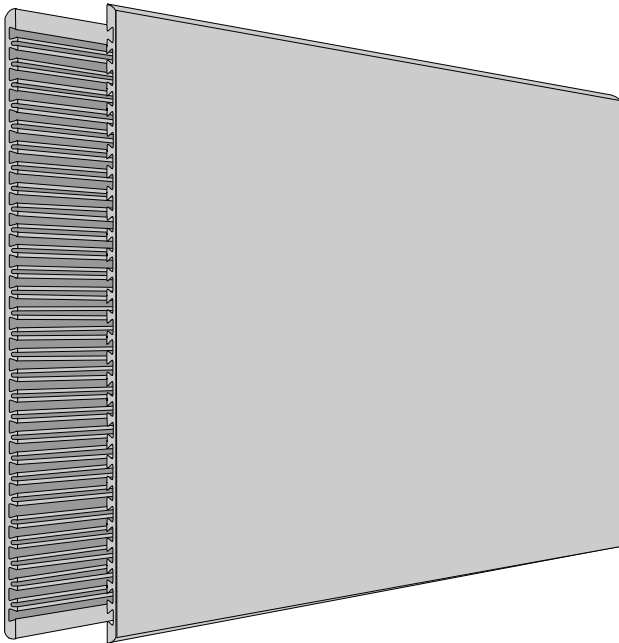

**MultiBases are available in Six Popular Sizes**  
45mm • 60mm • 75mm • 90mm • 120mm • 150mm

The **MultiBase** combines the look of a NEXUS FacePlate with the function of our BasePlate. The new design can be substituted for traditional NEXUS FacePlates and MountPlates in the available sizes. We have taken great care to ensure that the NEXUS standard of quality is not compromised.

In addition to being lighter, the **MultiBase** is more modular than the MountPlate. Changing a single plate to a multiple plate sign no longer means purchasing an entirely new sign. Only the



**150mm x 450mm MultiBase. 150mm x 150mm MultiFace.**  
**60mm x 300mm MultiFace. 2 - 45mm x 300mm MultiFaces.**

FacePlate needs to be changed, without the need to remove the sign from the wall.

Plus ... the **MultiBase** is a more economical solution to single plate signs. Not only are the unit costs lower, but the reduced weight means lower shipping costs. See the price comparison on the opposite page.

The benefits of the **MultiBase** system are truly maximized on small directories. As we have done in the sample above, you can create totally dynamic signs with our wide range of sizes, in an endless combination of FacePlates, for the ultimate in utility and economy!

The **MultiBase** is available in six sizes - 45mm, 60mm, 75mm, 90mm, 120mm and 150mm, in either the Cap Look or the Rail Look ... in stock in our standard clear anodized, brush finish.

How convinced are we that you'll see the benefits of the new **MultiBase** System? We'll send you one FREE ... no charge ... gratis ... on the house ... well, you get the idea!

Just phone, fax or eMail us your interest and we'll ship a 60mm sample to you the next day!

In the meantime, keep those cards and letters coming ... WE REALLY DO LISTEN!

*See reverse side for examples of MultiBase Prices*

**AS&G Lettering Systems Inc.**

Fax: (416) 285-8971 • 1-800-265-5047 • eMail: sales@nexussign.com • Web: www.nexussign.com • Phone: (416) 285-8531 • 1-800-542-8531



Cap Look - **Single**

**Single MultiFace/MultiBase System.**  
MultiFace in a 400 brushed finish, anodized clear.  
MultiBase anodized clear. Rails anodized clear, black, bronze or gold. Assembled complete with Splines and foam tape or holes.

Length:	150 <sub>MM</sub>	200 <sub>MM</sub>	250 <sub>MM</sub>	300 <sub>MM</sub>	400 <sub>MM</sub>
MultiFace	(6")	(8")	(10")	(12")	(16")
45 <sub>MM</sub> (1 <sup>3</sup> / <sub>4</sub> ")	\$14.70	\$16.20	\$17.80	\$19.40	\$22.50
60 <sub>MM</sub> (2 <sup>3</sup> / <sub>8</sub> ")	15.90	17.90	19.90	21.90	26.10
75 <sub>MM</sub> (3")	17.70	20.10	22.50	24.90	29.80
90 <sub>MM</sub> (3 <sup>1</sup> / <sub>2</sub> ")	21.30	24.10	26.80	29.60	35.20
120 <sub>MM</sub> (4 <sup>3</sup> / <sub>4</sub> ")	23.80	27.30	30.80	34.20	41.20
150 <sub>MM</sub> (6")	30.10	34.50	38.80	43.20	51.90

**Single FacePlate/MountPlate System.**  
FacePlate in a 400 brushed finish, anodized clear.  
MountPlate anodized clear. Rails anodized clear, black, bronze or gold. Assembled complete with Splines and foam tape or holes.

Length:	150 <sub>MM</sub>	200 <sub>MM</sub>	250 <sub>MM</sub>	300 <sub>MM</sub>	400 <sub>MM</sub>
FacePlate	(6")	(8")	(10")	(12")	(16")
45 <sub>MM</sub> (1 <sup>3</sup> / <sub>4</sub> ")	\$16.70	18.90	21.30	23.60	28.30
60 <sub>MM</sub> (2 <sup>3</sup> / <sub>8</sub> ")	19.10	22.10	25.10	28.10	34.20
75 <sub>MM</sub> (3")	22.40	25.90	29.70	33.40	40.80
90 <sub>MM</sub> (3 <sup>1</sup> / <sub>2</sub> ")	25.10	29.20	33.20	37.30	45.40
120 <sub>MM</sub> (4 <sup>3</sup> / <sub>4</sub> ")	29.20	33.90	38.80	43.50	53.10
150 <sub>MM</sub> (6")	35.80	41.80	47.80	53.80	65.80



Rail Look - **Multiple**

**Multiple FacePlates or MultiPlates/MultiBase System.**  
FacePlate or MultiFace\* in a 400 brushed finish, anodized clear. Rails anodized clear, black, bronze or gold. MultiBase anodized clear. Assembled complete with Splines and foam tape or holes.

Length:	150 <sub>MM</sub>	200 <sub>MM</sub>	250 <sub>MM</sub>	300 <sub>MM</sub>	400 <sub>MM</sub>
FacePlate/MultiPlate	(6")	(8")	(10")	(12")	(16")
<b>150<sub>MM</sub> MultiBase</b>					
15 <sub>MM</sub> (5/8")	\$ 7.80	\$ 8.70	\$ 9.50	\$10.40	\$12.10
20 <sub>MM</sub> (3/4")	8.90	9.90	10.80	11.80	13.60
25 <sub>MM</sub> (1")	10.30	11.50	12.60	13.80	16.10
30 <sub>MM</sub> (1 <sup>1</sup> / <sub>8</sub> ")	11.30	12.60	13.90	15.20	17.70
40 <sub>MM</sub> (1 <sup>1</sup> / <sub>2</sub> ")	13.70	15.20	16.70	18.30	21.30
45 <sub>MM</sub> * (1 <sup>3</sup> / <sub>4</sub> ")	14.40	15.90	17.40	18.90	21.90
50 <sub>MM</sub> (2")	16.20	17.90	19.90	21.70	25.40
60 <sub>MM</sub> * (2 <sup>3</sup> / <sub>8</sub> ")	17.90	19.90	21.90	23.90	27.90
75 <sub>MM</sub> * (3")	21.50	23.90	26.20	28.60	33.30
90 <sub>MM</sub> * (3 <sup>1</sup> / <sub>2</sub> ")	25.70	28.50	31.20	33.90	39.40
100 <sub>MM</sub> (4")	29.80	33.40	36.90	40.60	47.80
120 <sub>MM</sub> * (4 <sup>3</sup> / <sub>4</sub> ")	32.10	35.50	38.90	42.40	49.20

**Multiple FacePlates/BasePlate System.**  
FacePlates in a 400 brushed finish, anodized clear. Edge BasePlates anodized clear. Rails anodized clear, black, bronze or gold. BasePlate anodized black. Assembled complete with Splines and foam tape or holes.

Length:	150 <sub>MM</sub>	200 <sub>MM</sub>	250 <sub>MM</sub>	300 <sub>MM</sub>	400 <sub>MM</sub>
FacePlate	(6")	(8")	(10")	(12")	(16")
<b>150<sub>MM</sub> BasePlate</b>					
15 <sub>MM</sub> (5/8")	9.10	9.90	10.90	11.90	13.80
20 <sub>MM</sub> (3/4")	10.70	11.70	12.80	13.90	15.90
25 <sub>MM</sub> (1")	12.60	13.90	15.20	16.50	19.20
30 <sub>MM</sub> (1 <sup>1</sup> / <sub>8</sub> ")	13.90	15.40	16.90	18.30	21.30
40 <sub>MM</sub> (1 <sup>1</sup> / <sub>2</sub> ")	17.30	19.10	20.80	22.60	26.20
45 <sub>MM</sub> (1 <sup>3</sup> / <sub>4</sub> ")	18.90	20.90	22.90	24.90	28.90
50 <sub>MM</sub> (2")	20.60	22.80	24.90	27.10	31.40
60 <sub>MM</sub> (2 <sup>3</sup> / <sub>8</sub> ")	23.90	26.40	28.80	31.50	36.70
75 <sub>MM</sub> (3")	28.90	31.90	35.10	38.20	44.40
90 <sub>MM</sub> (3 <sup>1</sup> / <sub>2</sub> ")	34.60	38.20	41.80	45.40	52.60
100 <sub>MM</sub> (4")	38.40	42.50	46.60	50.70	58.90
120 <sub>MM</sub> (4 <sup>3</sup> / <sub>4</sub> ")	44.10	48.70	53.30	57.90	67.10

Phone, fax or eMail for complete 2003 Nexus Cap and Rail Price Lists

AS&G Lettering Systems Inc.

U.S. Address:

4500 Witmer Industrial Estates, Niagara Falls, NY 14305  
Fax: 1-800-265-5047 Phone: 1-800-542-8531  
eMail: sales@nexussign.com Web: www.nexussign.com



Head Office and Plant:

11 Canadian Road, Unit 6, Toronto, ON M1R 5G1  
Fax: (416) 285-8971 Phone: (416) 285-8531  
1-800-265-5047 1-800-542-8531